

2

1

1

WELDED BASE

2

METALLIC SLEEVE

4

MAGNESIUM OXIDE

7

CERAMIC HEAD

B

B

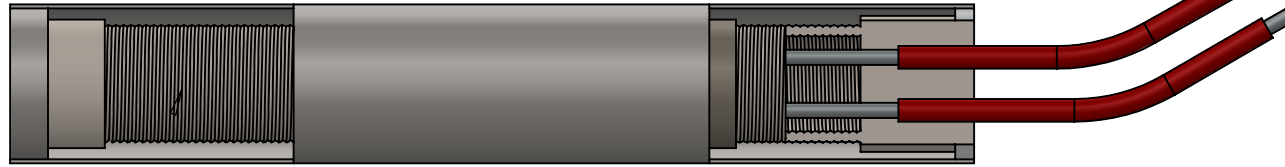

CERAMIC DISC

HEATER WIRE

CERAMIC CORE

HARD REFRACTING PASTE

CONDUCTOR LEAD

3

5

6

9

8

**NOTES:**

1 WATERTIGHT TIG WELD BASE CAPABLE OF WITHSTANDING MAX PRESSURE OF 60KG/CM<sup>2</sup>

2 SS AISI 304/316/321/INCOLOY

3 INSULATOR

4 GRANULOMETRIC MAGNESIUM OXIDE, PURE

5 NICKEL-CHROMIUM 80/20 WITH 1400°C MELTING POINT

6 CERAMIC

7 HARD CERAMIC

8 LEADS

9 SEAL

A

**BCE**

TITLE:

# COMPOSITION OF CARTRIDGE HEATERS

SIZE

**A**

DWG. NO.

**MHC4845**

REV

**A**

SCALE: NTS

WEIGHT: N/A

SHEET 1 OF 1

**PROPRIETARY AND CONFIDENTIAL**

THE INFORMATION CONTAINED IN THIS DRAWING IS THE SOLE PROPERTY OF BELILOVE COMPANY ENGINEERS. ANY REPRODUCTION IN PART OR AS A WHOLE WITHOUT THE WRITTEN PERMISSION OF BELILOVE COMPANY ENGINEERS IS PROHIBITED.

2

1

A