

**DRAWING FOR REFERENCE ONLY -**

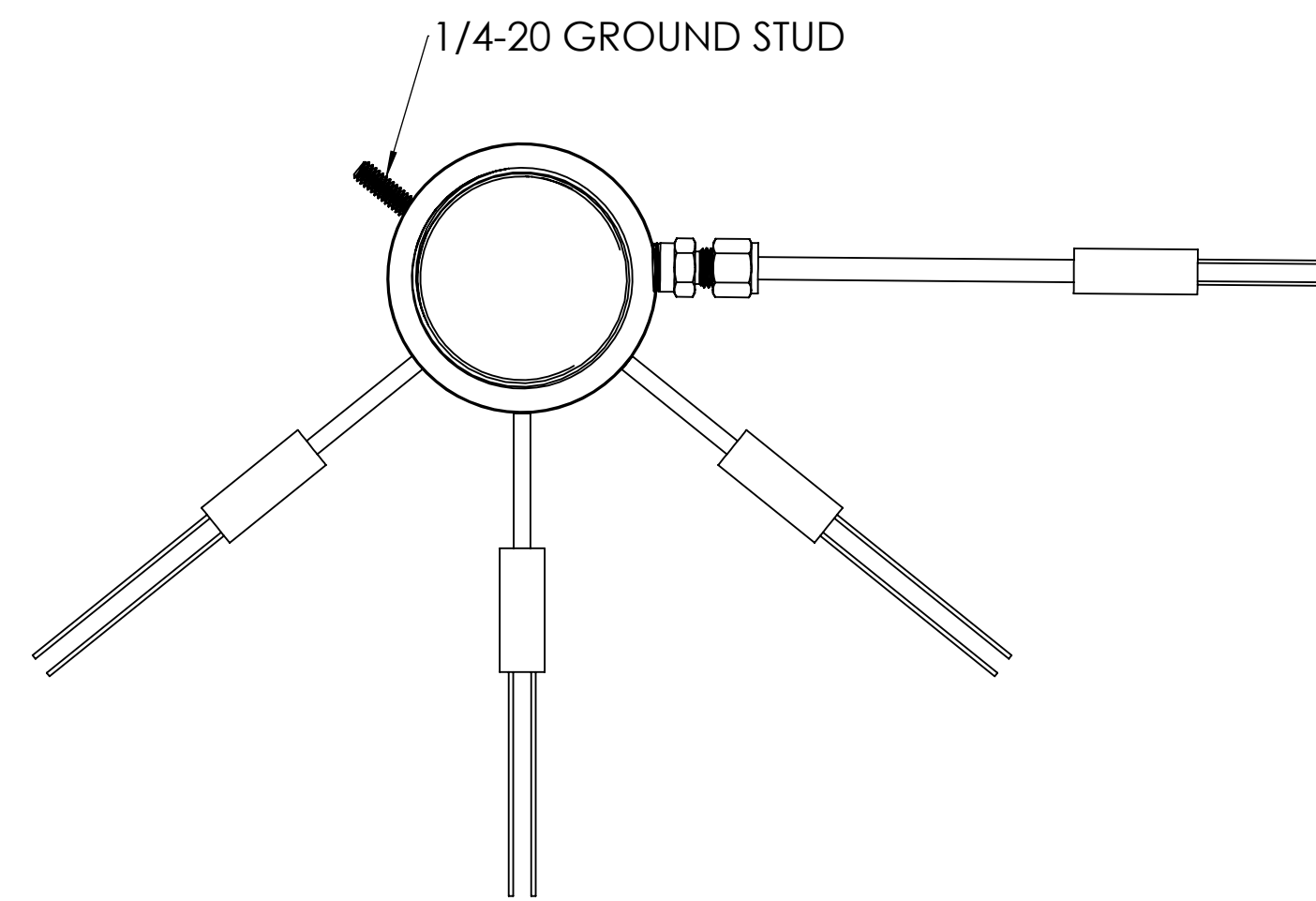

2X 2" NPT  
304 STAINLESS STEEL

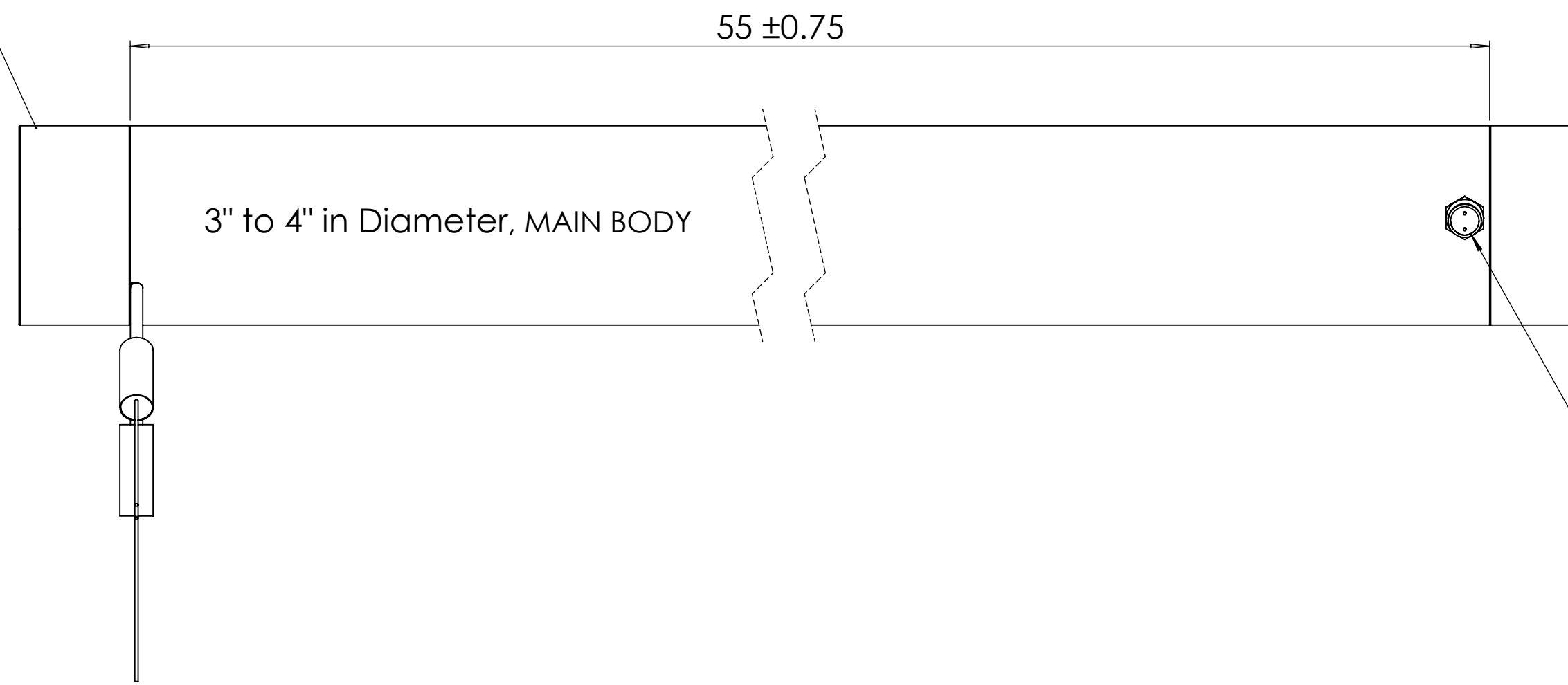

3" to 4" in Diameter, MAIN BODY

55 ± 0.75

1/4" TYPE K EXPOSED THERMOCOUPLE  
COMPRESSION ASSEMBLY NEAR OUTLET

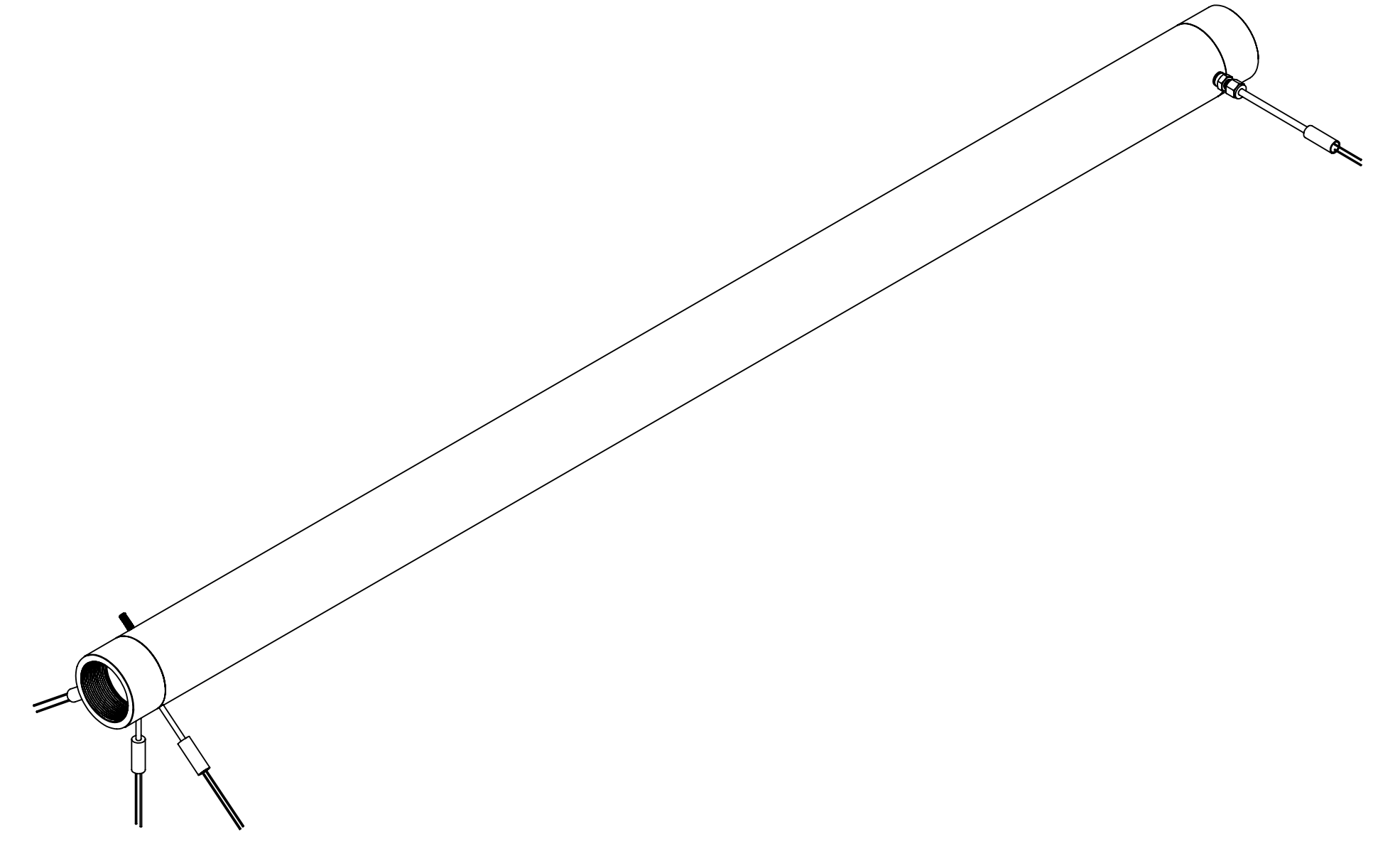

1. ELECTRICAL: 22 kW(+/- 10%) 480 VOLTS SINGLE/3-PHASE -36" FIBERGLASS LEADS, TEFLON, OR KAPTON, W/ 12' SS WIRE BRAID
2. 1/4" TYPE K EXPOSED THERMOCOUPLE OR PROBE STYLE COMPRESSION ASSEMBLY NEAR OUTLET
3. STAINLESS STEEL 304 MAIN BODY 3" to 4" DIAMETER, STAINLESS STEEL 304 2" NPT , 304SS HEAT SOURCE

**4. OPERATION:**

- A) HIGH POT TEST TO 700VDC @ 0.5mA FOR 5 SECONDS
- B) USER TO MAKE SURE LEADWIRE TO CASING HAS AT LEAST 2 M-OHM PRIOR TO ENERGIZING
- C) **DO NOT BRING TO FULL POWER ON COLD START!** USE 50% POWER FOR 15 MIN OR LONGER PRIOR TO OPERATING TEMP.
- D) IF UNIT IS UNDER 2 M-OHM, BAKE OUT HEATER AS NECESSARY PRIOR TO OPERATING.

5. BCE TO CHEMICALLY CLEAN WITH IPA, BAG & TAG WITH PN.

6. ASSEMBLY TO BE POWERED UP & RAMPED IN ATMOSPHERE AT BCE PRIOR TO SHIPMENT. DISCOLORATION MAY BE PRESENT.

7. BCE TO PRESSURE TEST HEATER TO 90 PSI AT 18-20C PRIOR TO SHIPMENT

8. DO NOT ENERGIZE WITHOUT MINIMUM FLOW BASED ON APPLICATION

**PROPRIETARY AND CONFIDENTIAL**  
THE INFORMATION CONTAINED IN THIS DRAWING IS THE SOLE PROPERTY OF BCE/CFG.  
ANY REPRODUCTION IN PART OR AS A WHOLE WITHOUT THE WRITTEN PERMISSION OF BCE/CFG IS PROHIBITED.

UNLESS OTHERWISE SPECIFIED:		NAME	DATE	21060 Corsair Blvd Hayward, CA 94545 <b>TITLE:</b> MCF HEATER, 3 PHASE, WITH TC <b>SIZE DWG. NO.</b> D BCE11369 <b>SCALE:</b> NTS WEIGHT: SHEET 1 OF 1
DIMENSIONS ARE IN INCHES		DRAWN	AJM	
TOLERANCES:		CHECKED	D.S	
FRACTIONAL ± ANGULAR: MACH ± BEND ± TWO PLACE DECIMAL ±0.015 THREE PLACE DECIMAL ±0.007		ENG APPR.	AJM	
INTERPRET GEOMETRIC TOLERANCING PER: MATERIAL		MFG APPR.		
FINISH		SEE NOTES		
APPLICATION	DO NOT SCALE DRAWING			